



**KARNATAKA ANTIBIOTICS &
PHARMACEUTICALS LIMITED**

(A Government of India Enterprise)

ENQUIRY REF. No.	KAPL/DH/ME/013/1427
DATE	20.11.2025
DUE DATE	27.11.2025 (13.00HRS)

Dear Sir,

Please submit your lowest and competitive offer in a SEALED ENVELOPE, DULY SUPERSCRIBING OUR ABOVE ENQUIRY REF. NO., DATE and DUE DATE on it/ with other details of F.O.R terms, Taxes, Credit period, Delivery offered, Name of the Make, Detailed Specification etc., for below mentioned material/s

SL. NO.	ITEM CODE	ITEM DESCRIPTION	UOM	QTY
01	MGW2739	11 MM ROUND DEEP GROOVE CONCAVE PUNCHES AND DIE	NOS	40

Please ensure that your offer reaches us on or before Due Date by courier OR Speed post or By hand in sealed cover only to below office address:

M/s. Karnataka Antibiotics and Pharmaceuticals Limited Plot No.37, Arka The Business Centre ,NTTF Main Road, Peenya Industrial Area 2nd Phase ,Bengaluru-560058 ph. No.080-23571590

OTHER TERMS:

- | | |
|---------------------------------|--------------------------------------|
| 1. F.O.R TERMS | : DOOR DELIVERY TO DHARWAD KARNATAKA |
| 2. GST % | : PLEASE SPECIFY |
| 3. PACKING & FORWARDING CHARGES | : NOT APPLICABLE |
| 4. CREDIT PERIOD | : 30 DAYS |
| 5. DELIVERY OFFERED | : |
| 6. ATTACHED PAGES | : 02 |

NOTE:

1).IF YOU ARE NOT PARTICIPATING IN THE TENDER PLEASE SEND A REGRET LETTER .

2).VENDER HAS TO QUOTE AS PER OUR TENDER IN YOUR COMPANY LETTER HEAD.

3).QUOTATION MUST BE SUBMITTED IN TWO SEALED COVERS (TECHNICAL&COMMERCIAL /PRICE BID)SEPARATELY AND IN ONE ENVELOP OR ELSE YOUR PROPOSAL WILL NOT BE CONSIDERED.

IF YOU NEED ANY CLARIFICATION , PLEASE CONTACT US.

Thanking you,

Yours faithfully,
For KARNATAKA ANTIBIOTICS
& PHARMACEUTICALS LIMITED

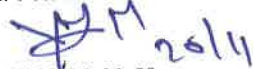

YUVARAJA M
DEPUTY MANAGER, PURCHASE DEPT

**KARNATAKA ANTIBIOTICS AND PHARMACEUTICALS LIMITED,
AYUSH PLANT- DHARWAD**

PR No. 2026D00185

Date: 31.10.2025

Sub: Tablet compression punch set (Upper punch, lower punch and dies)

S.No	Item Code	Technical Specification		Qty
1	MGW2739	11 mm round deep concave punch & die set 'B' tooling		40 Nos
		MOC of Punch	S-7	
		MOC of die	HCHC D3P	
		Inspection report	Must be given	
		MOC certificate	Must be given	
		Tool Drawing	Approval must be taken before manufacturing of punches	
		Punch Tooling PVC box	Must be given	
		Shape of tablet	Deep grove convex type, round shape	

Reference Diagram attached

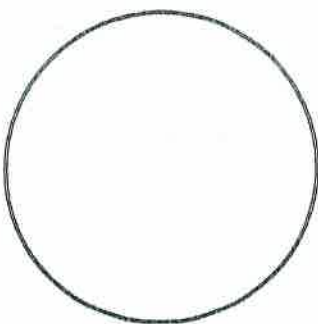
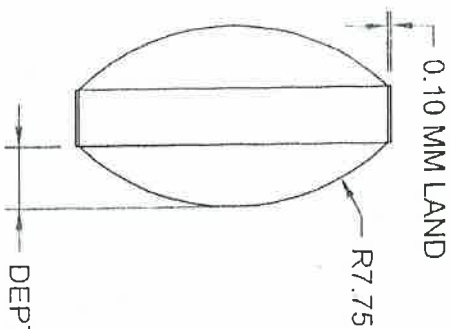
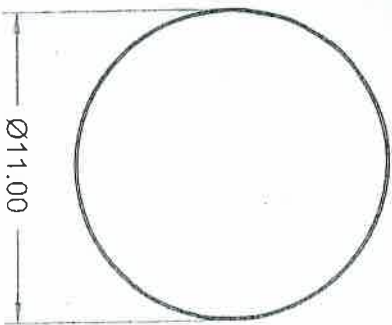

Reference Diagram

SCALE 4 : 1

UPPER PUNCH TIP SIZE		LOWER PUNCH TIP SIZE		DIE POCKET SIZE	
10.96 ^{+0.00} / _{-0.02}		10.97 ^{+0.06} / _{-0.02}		11.00 ^{+0.02} / _{-0.00}	
<p>NOTES:</p> <p>1. ALL DIMENSIONS ARE IN MM.</p> <p>2. DRAWING REFLECTS THE TABLET FACE WITHOUT EXPANSION</p> <p>3. DRAWING MADE AS PER STANDARD SPECIFICATIONS.</p> <p>4. ALL RIGHTS RESERVED FOR THE DRAWING BY SHANDEW. THE DRAWING SHOULD NOT BE COPIED IN PART OR WHOLE WITHOUT PRIOR WRITTEN CONSENT OF SHANDEW.</p>					
TYPE OF TOOLING		CAPACITY IN TONS		CLIENT	
B		6.5		KARNALI AKA ANTI BIOTICS & PHARMACEUTICALS LTD.	
UPPER PUNCH QTY	LOWER PUNCH QTY	DIE QTY	SIZE : DIA 11.00 MM ROUND R-7.75		
40 PL	40 PL	40	DRG. NO. KAPL-002-22		
SCALE 4 : 1			DATE 29.04.2022		
			REV NO 1		



Nagarabhav
ne@gmail.co

10/2025

ON SERVICE